



Fernhead Road, London, W9 3EB
Asking Price £475,000 Leasehold





2 x  1 x  1 x 

A two bedroom flat on the first floor of a period building on Fernhead road, offering a great opportunity to create a lovely home as the flat measures a generous 659 sq ft. The accommodation benefits from high ceilings and an abundance of natural light, with a good sized reception and separate kitchen, double bedroom, single bedroom and family bathroom. Close to the amenities of the Harrow Road, Westbourne Park Tube and the cafes and bars of Maida Vale.



Fernhead Road, London W9

Approximate Gross Internal Area

659 sq ft - 61 sq m

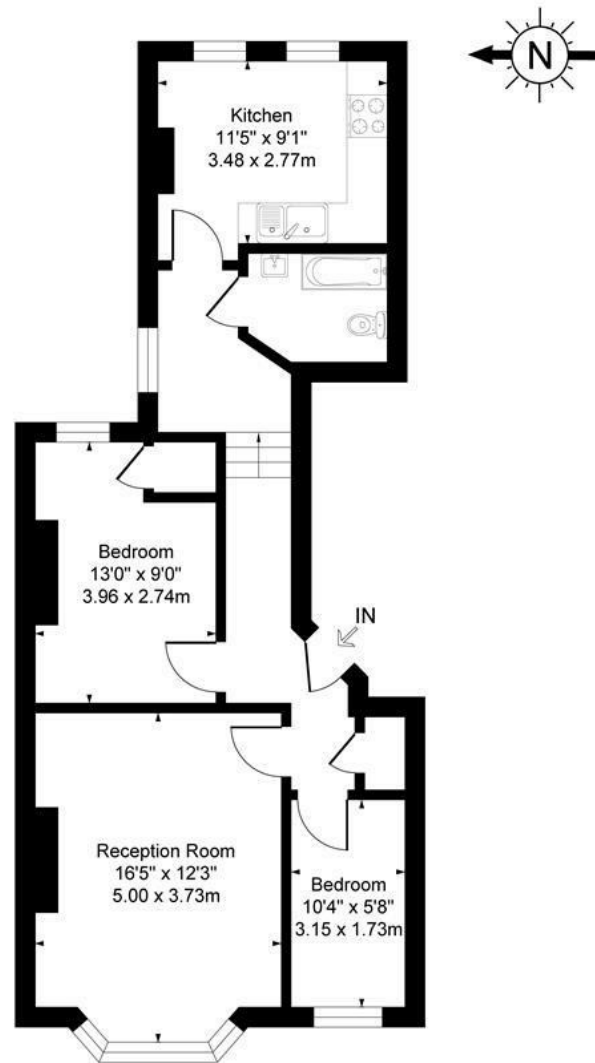

First Floor

Illustration for identification purposes only, not to scale

Important Notice Debussy Property Service Ltd trading as Braithwait for themselves and for the vendor of this property whose agents they are, give notice that (i) these particulars do not constitute any part of an offer or contract, (ii) all statements contained within these particulars are made without responsibility on the part of Braithwait or the vendor, (iii) whilst none in good faith, none of the statements contained within these particulars are to be relied upon as a statement of representation or fact, (iv) any intending purchaser must satisfy him/herself by inspection or otherwise as to the correctness of each of the statements contained within these particulars, (v) the vendor does not make or give either Braithwait or any person within their employment any authority to make or give any representation or warranty whatsoever in relation to this property. Wide angled lenses may be used in photographs.

Call us on 0207 289 8889 or email sales@braithwait.co.uk

